

## Technical specification

- 1 Worktop** - MFC 1 1/8" (28 mm), ABS edge 1/8" (2 mm)
- 2 Frame with electric height adjustment** - metal, powder coated, 3 profiles 2" x 2" (50 x 50 mm), 2 1/8" x 2 1/8" (55 x 55 mm) and 2 3/8" x 2 3/8" (60 x 60 mm)
- 3 Foot** - powder coated metal
- 4 Control panel** - stepless height adjustment:
  - A** - basic control panel; the sensitivity of the anti-collision system is set to Medium
  - B** - OPTION WITH EXTRA CHARGE - up and down keypad with memory; the ability to change the sensitivity of the anti-collision system within 3 levels: Low, Medium, High
  - C** - OPTION WITH EXTRA CHARGE - round control panel with memory; the ability to change the sensitivity of the anti-collision system within 3 levels: Low, Medium, High; mounted to the worktop
- 5 Leveling** - 3/8" (10 mm) range; OPTION WITH EXTRA CHARGE - castors

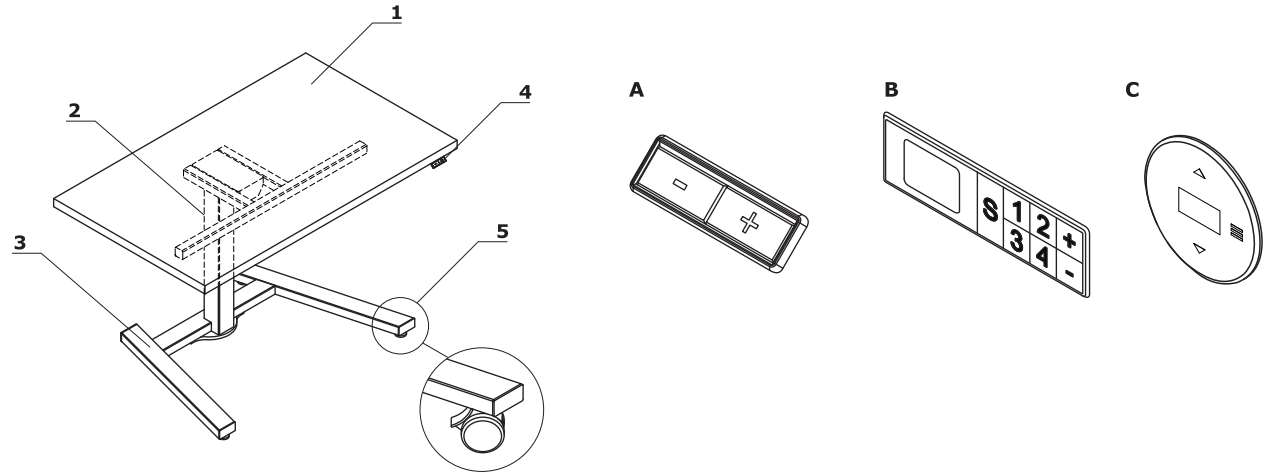

## Dimensions (inch/mm)

